



350 Series Above Panel / Pocket Installation Guide



AeroCatch® 3XS kit contents:

- 2 x AeroCatch® 3XS
- 1 x Fastener Pack

Operation

Before starting please familiarise yourself with the AeroCatch® 3XS. Depress the square shaped secondary lock button and lift handle until you override the handle hold-up detent, around 110°.

At this position, the draw hook is clear of the strike allowing the panels to be pulled apart and the shear tongue disengaged.

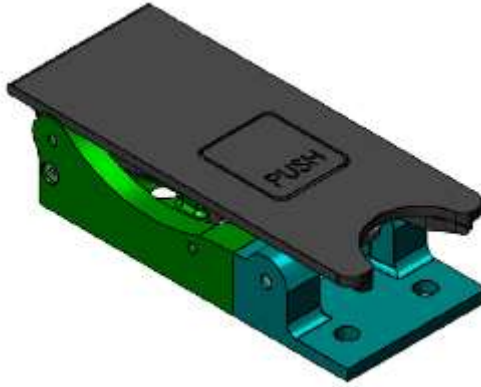

To close the latch, put the panels together and engage the shear tongue, push the handle down until the draw hook engages the strike, pulls the panels together and the secondary lock button snaps in position. An audible click can be heard as it locks.

Installation

Once you have unpacked your AeroCatch® 3XS kit you will need to mark the panel. You can either mark through the fixing holes directly onto the panel or make a template using the dimensions from the installation drawing.

First clamp the two panels together in the required position.
Lay your template out to determine the centre line of the latch and the panel split line.

PANEL PREPARATION

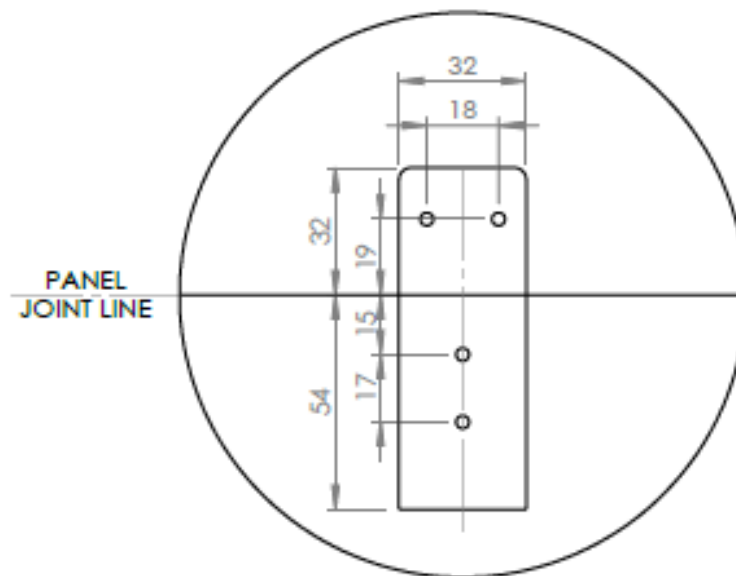

Check that there is sufficient room below the panel for the housings and the location is either flat or with minimal radius. Place the template onto the panel. Line up the split lines with the edge of the panel and mark the fixing holes.

Care of your AeroCatch® 3XS

To optimise performance of your AeroCatch® 3XS, clean mechanism regularly with a small brush and lubricate with a light oil spray wiping away any excess.

Technical Support

Should you encounter problems or wish to use it in a different application area please call our technical support +44 (0) 1803 868677 or email sales@aerocatch.com.

